

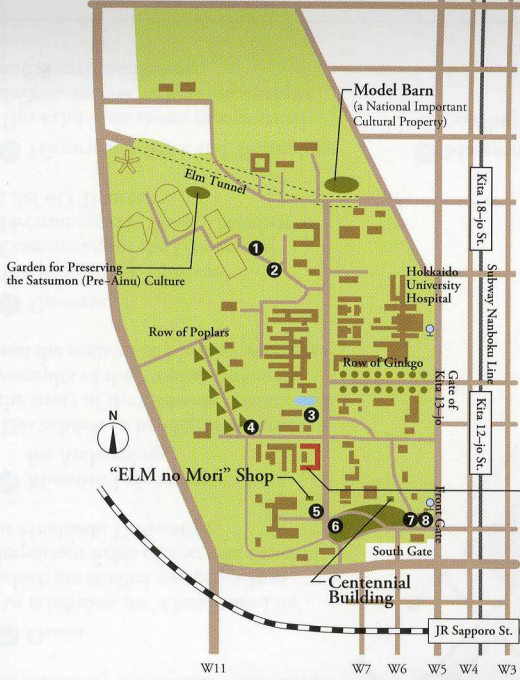

Title	An Introduction to The Hokkaido University Museum : History of Hokkaido University, Academic Thematic Exhibition, Academic Exhibition of Specimens
Citation	博物館展示 / 大学の知をすべての人々に！ . 平成20年6月15日 ~ 平成20年7月31日 . 札幌市
Issue Date	2008-06-15
Doc URL	http://hdl.handle.net/2115/34601
Type	other
File Information	43-1.pdf



[Instructions for use](#)



- 1 Monument to Keiteki Dormitory
 - 2 Monument to Miyako-Zo-Yayoi, which is the song of Hokkaido University's dormitory
 - 3 Monument of an Artificial Snowflake
 - 4 Monument to Mr. Inazo Nitobe
 - 5 Monument that Showa Emperor Visited
 - 6 Statue of Dr. William S. Clark
 - 7 Monument to the Preparatory Course of Hokkaido University
 - 8 Statue of Mr. Shosuke Sato
- Bus Stop

THE HOKKAIDO UNIVERSITY MUSEUM



Information on facilities related to the Hokkaido University Museum



Botanic Garden / Museum

This was built in 1884 and mainly exhibits reference materials on archaeology and history, and the Ainu. TARO, a famous dog of a winter expedition to the South Pole, and the Ezo Wolf are popular items on display.



Model Barn

This was built as the second farm of Sapporo Agricultural School in 1877. It was nominated as a National Cultural Heritage site as the oldest Western-style building.



Centennial Building

This was built as one of the projects marking the 100-year Anniversary of Hokkaido University in 1977. There are a big conference room and a restaurant on the 1st floor and reference material explaining the history of 100 years of Hokkaido University on the 2nd floor.



'ELM no Mori' Shop

The shop was opened in 2003. This space was used as the classroom for learning entomology and sericulture at the time of Sapporo Agricultural School. Now it is used for public relations of Hokkaido University and as a salon for citizens and tourists.

E-mail: museum-jmu@museum.hokudai.ac.jp
 URL: <http://www.museum.hokudai.ac.jp/>
 Fax: +81-(0)11-706-4029
 Phone: +81-(0)11-706-2658 (in Japanese)
 Hokkaido 060-0810 JAPAN
 Kita 10, Nishi 8, Kita-ku, Sapporo-shi.

THE HOKKAIDO UNIVERSITY MUSEUM

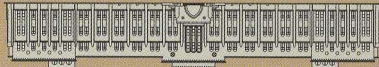

● Admission Free

*There will be exceptions to this schedule because of events at the University open on the holiday and closed the following Tuesday instead (except for National Holidays on Monday, in which case the Museum is closed on Mondays and year-end holidays (December 29-January 3))

● Open Hours
 10:00-16:00 (From June to October: 9:30-16:30)

Opening Hours and Admissions

Access to the Museum
 10-minute-walk from North Exit of JR Sapporo station. There is no parking area around the Museum. When you visit the Museum, please use public transportation, such as bus and subway.

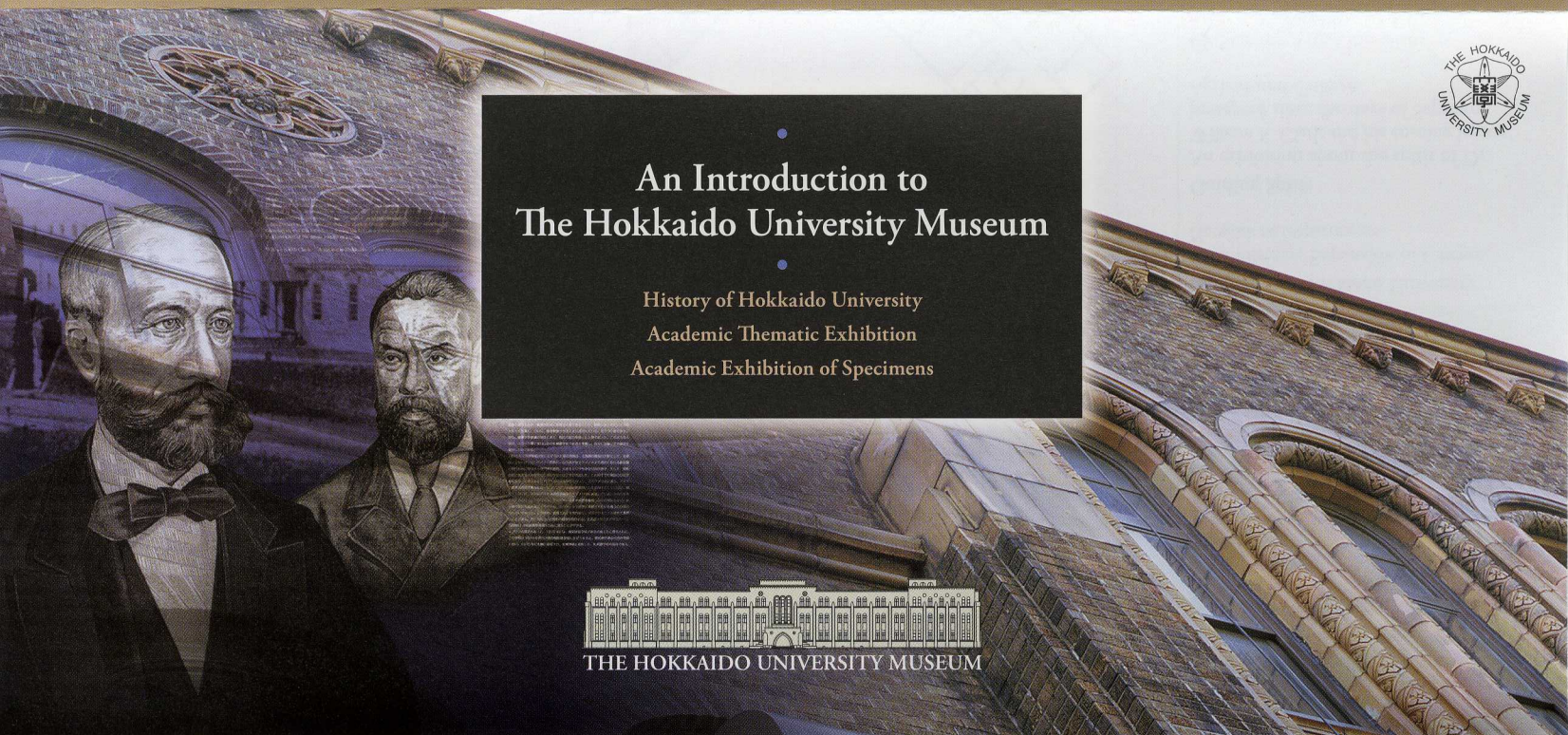

An Introduction to The Hokkaido University Museum

History of Hokkaido University
 Academic Thematic Exhibition
 Academic Exhibition of Specimens



THE HOKKAIDO UNIVERSITY MUSEUM

The Concept of The Hokkaido University Museum

- (1) The Museum holds irreplaceable collections of specimens and academic material begun by Sapporo Agricultural College, now Hokkaido University, upon the foundation of the College in 1876. The Museum was established to promote the use of these collections for projects that cannot be undertaken digitally: such materials, not otherwise reproducible, are of unique importance in research that focuses on 'practical' science and 'field- and object-based' study.
- (2) The Museum makes full use of Hokkaido's geographical position and geomorphological character to undertake educational and research projects that center on the area embraced by Eurasia, the Sea of Okhotsk and the Arctic Circle.
- (3) The Museum seeks to encourage young people with talent and imagination to construct a sustainable society in which citizens can lead comfortable lives in harmony with their natural environment, while also undertaking research into such questions as the history of the earth and the evolution of biodiversity, to better understand the origin and genealogy of mankind and the growth of human culture.
- (4) The Museum hopes to establish Sapporo as a model city with a full and rich cultural life.

Academic Thematic Exhibition

8 Academic Themes and Perspectives

An exhibition introducing a selected few of the numerous research themes actively pursued at Hokkaido University.



The Eruption of Mt. Usu in 2000

9 Ecosystems

Hokkaido University has experimental forests, agricultural fields, and marine laboratories, where large-scale instrument-based field investigations are conducted. This section shows the relationship between human beings and nature, focusing on four ecosystems: forest, rural area, urban area, and ocean.

10 Life-Diversity and Universality

The various forms and phenomena exhibited by living organisms inhabiting the Earth are much to be admired. This section displays the results of some studies in the life sciences that form part of the research on diversity.



Diversity of Insects

11 Humankind and Technology

Hokkaido University, which was founded with a mission to contribute to the development of Hokkaido, has accomplished a great deal in the engineering and industrial-research fields. As there is a clear need to overcome the principle of large-scale production and consumption that prevailed in the 20th century, we must now shoulder more responsibility for our society and environment. The exhibits in this section offer new ideas on research techniques required to break fresh ground in the 21st Century.

12 Northern Biota- Evidence for a Changing Northeast Eurasia

The Biota of Sakhalin, the Kuriles, Kamchatka, and Siberia, the region located to the north of Hokkaido, is one of the main objects of the field-science studies conducted at Hokkaido University. This section shows studies pertaining to these northern areas.



Kuriles: Crater Bay located in the Ushishir Islands

13 Sustainable Campus

This exhibition shows specimens, documents, and facilities used for continuing research at the campus of Hokkaido University.

14 Bibliothecae of Hokkaido University

This exhibition shows invaluable books in the library of Hokkaido University.

15 Ocean

An exhibition on "Ocean and Life", which are studied energetically as important fields of scientific research at Hokkaido University.

16 Museum Laboratory for Archaeology

This exhibition highlights advances in the study of the Okhotsk culture, with examples of the Kafukai settlement and the remains of Moyoro cemetery.

17 Universe

The Birth of the Universe/
Examination of the Universe by
Electromagnetic Waves / Stardust to
Life/ 4D Theater.

18 History of Science and Technology

This exhibition shows experimental devices, such as various microscopes and electric oscillators.

3rd Floor

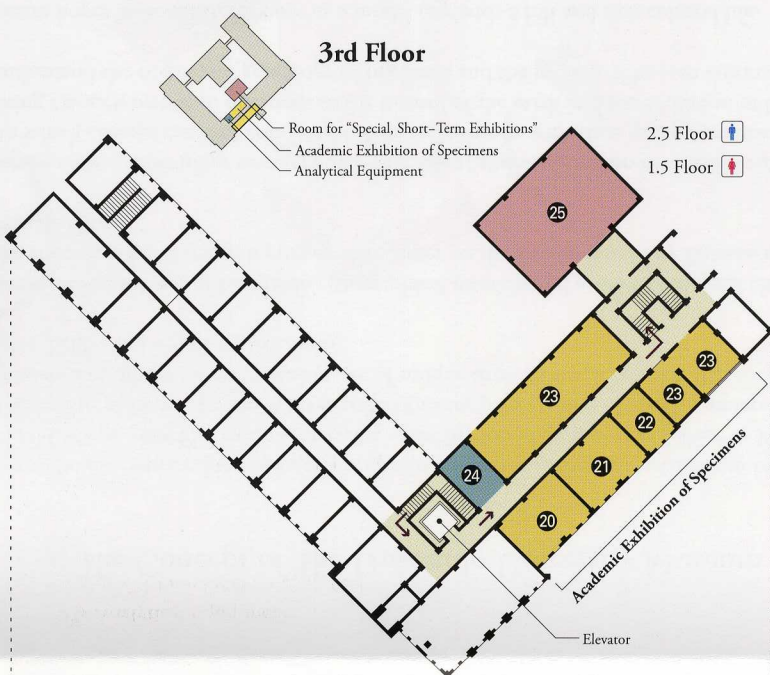

24 Analytical Equipment

An exhibition of various analytical instruments used for the analysis of specimens in research and teaching.

25 Room for "Special, Short-Term Exhibitions"

A special exhibition based on a specific theme and held for a certain period of time.

2nd Floor



19 Reference Room

The room is for queries about the exhibits and the activities of this museum.

1st Floor



26 Museum Shop

You can buy original goods and books.

Academic Exhibition of Specimens

20 Skeletal Preparations

This exhibition shows skeletal specimens of mammals from the Department of Veterinary Sciences, Hokkaido University.

21 Specimens from the Herbarium and Entomological Specimens

This exhibition shows botanical and insect specimens preserved at Hokkaido University.

22 Moulage

An exhibition of wax models showing various skin diseases. These models were created in the laboratory of dermatology at the School of Medicine, Hokkaido University.

23 Island Arc—Geological Specimens and Their History

The Japanese Islands are located in the "island arc-trench system" surrounding the Pacific from Southeast Asia to North America. This exhibition shows some fossils and various rocks, minerals, ores, and strata that were generated by changes in the island arc from the late Cretaceous to the Cenozoic Periods.



Nipponosaurus (left) and Desmostylus (right)

History of Hokkaido University

1 Guide to Hokkaido University

Brief History; Expansion of Campus; Network of Departments.

Guiding Spirit

An exhibition about the spirit of Dr. William S. Clark and his ensuing legacy preserved since the days of Sapporo Agricultural College.

2 Starting with Liberalism

The Mind of Liberalism, Puritanism, and Humanism; *En-Yu* Night School; Mind of Independence; Unyielding Spirit; Encouragement for Work.

3 The Undying Spirit of Sapporo Agricultural College

Dr. Clark and Hokkaido University; Nationwide Influence—Inazo Nitobe, Kanzo Uchimura, Takeo Arishima, and Masatake Oshima; The Succession to Today—Ideas of the Alumni on the Spirit of Hokkaido University.

4 The Spirit of Practical Science

Botany: Kingo Miyabe
Plant Pathology: Seiya Ito
Genetics: Hitoshi Kihara
Biogeography: Shozaburo Watase
Veterinary Science: Koichi Ichikawa
Zoology: Saburo Hatta
Entomology: Shonen Matsumura
Civil Engineering: Isami Hiroi.

5 Lofty Ambition: A Timeline

Frontier Spirit—Graduates who Contributed to Pioneering the Development of Hokkaido; A Global Viewpoint; Stockholm Water Prize.



The Undying Spirit of Sapporo Agricultural College

Contributions to the World of Science

This facility enhances the intellect by holding mini-symposiums and public seminars and by displaying documents, experimental devices, and real specimens.

6 Exchange of Intellect

Portrait: Mashiho Chiri & Ukichiro Nakaya; Peculiar Study Fields—Deep Seabed, Cosmos, Highlands, and Polar Regions.

7 Intellectual Achievement

Introduction to Study Areas and Research Facilities of Hokkaido University / Database of the Academic Specimens in the General Museum / 100 Alumni of Hokkaido University over the Last Century.